



# Digital Transformation & Sustainability

## Symetri BIM Forum 2022

Thomas Gregersen  
Sr. Technical Sales Specialist

# Transformation to Digital

## A brief walk-through history

- Becoming digital
  - Paper to Bytes
- Focusing on objects
  - Lines & Arc's to Objects
- Adding a dimension
  - 2D to 3D
- Information at the center
  - CAD to BIM
- Becoming collaborative

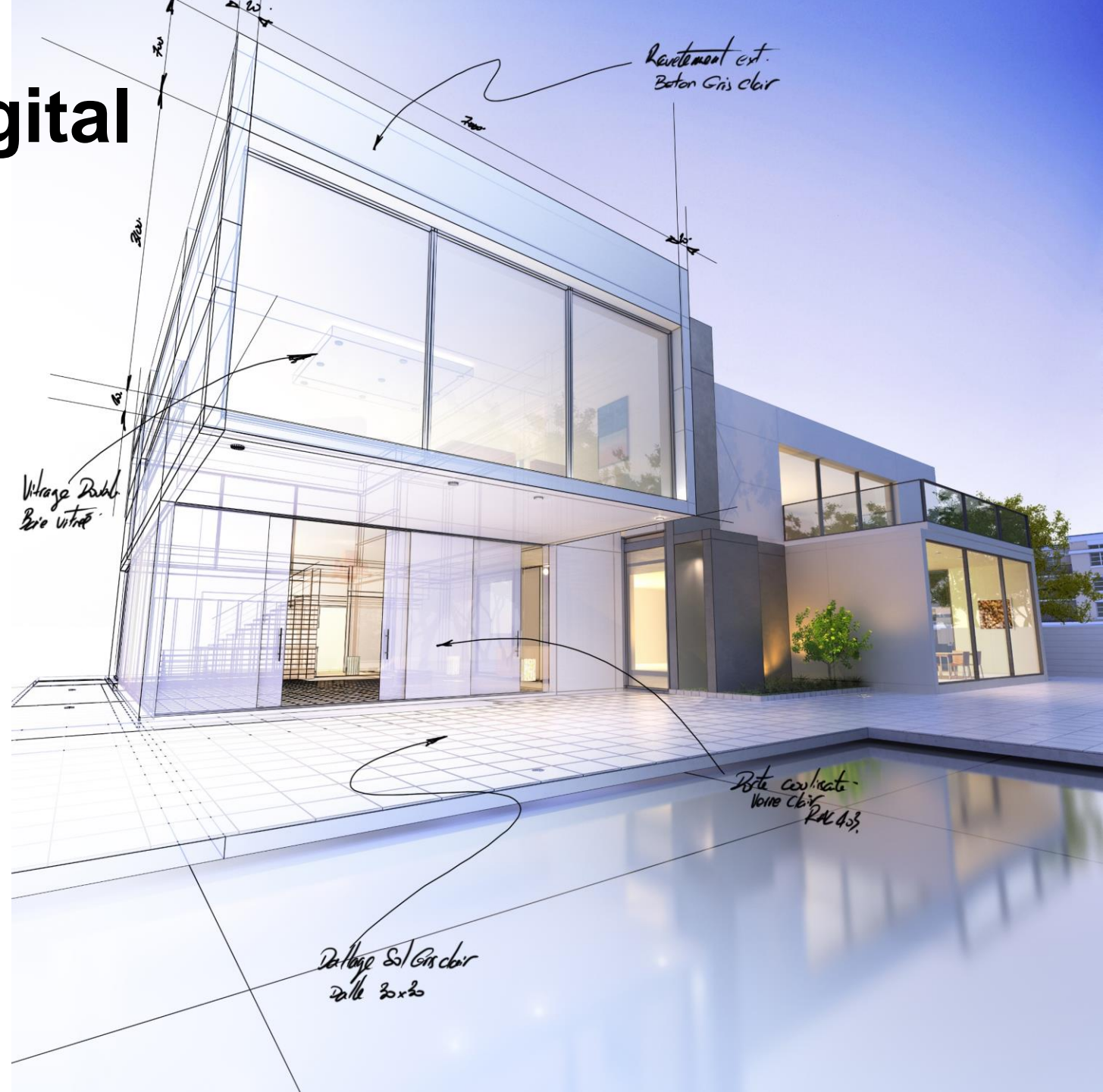



# What is sustainability?

Collaboration will be key to achieving the sustainable development goals

In the broadest sense, sustainability refers to the ability to maintain or support a process continuously over time.

The Autodesk logo, a stylized 'A' with a downward-pointing arrow, and the word 'AUTODESK' in large, white, sans-serif capital letters are mounted on a dense, vertical garden wall. The wall is composed of various green plants, including leafy vines and ferns. A person is walking past the wall on the right side of the frame, partially visible and slightly blurred.

**AUTODESK**

Collaboration is essential to produce the distinctive forms of science and technology - knowledge and know-how - required to meet sustainability challenges.



# Sustainability Development Goals

## UN Sustainable Development Goals: Autodesk customer commitments



SDG	UN Sustainable Development Goal	%
	Climate Action	69%
	Responsible Consumption and Production	65%
	Affordable and Clean Energy	64%
	Industry Innovation and Infrastructure	64%
	Sustainable Cities and Communities	50%
	Decent Work and Economic Growth	46%

# From SDGs to Initiatives

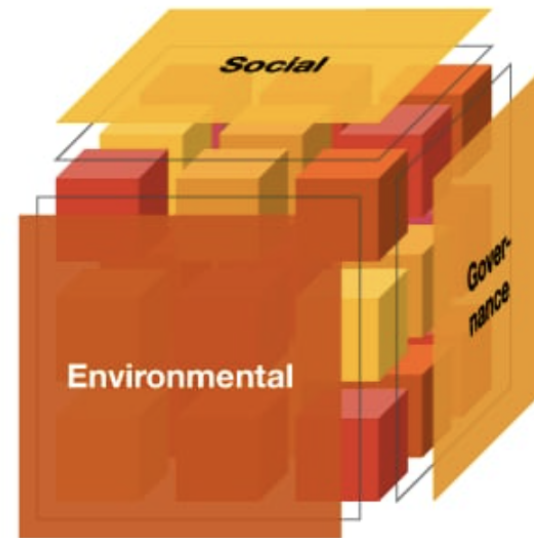

## Environmental

- Net Zero initiatives
- E-mobility
- Responsible resource management

## Social

- Social security systems
- Research, education, innovation
- Security, public order and open society

## Governance

- Good governance
- Digitization strategies
- Location development

# Becoming Collaborative

## Why digital collaboration is changing the game

- Data sharing
  - Multiple Stakeholders
    - Basic file storage & sharing
    - Version control
  - Anytime, anywhere collaboration
  - Common data environment
  - Design Review on-the-go
  - Automated clash detection
- Digital Governance
  - Manage design data exchange & submittals
  - Centralized Issue Management



# Data Sharing

Becoming Collaborative

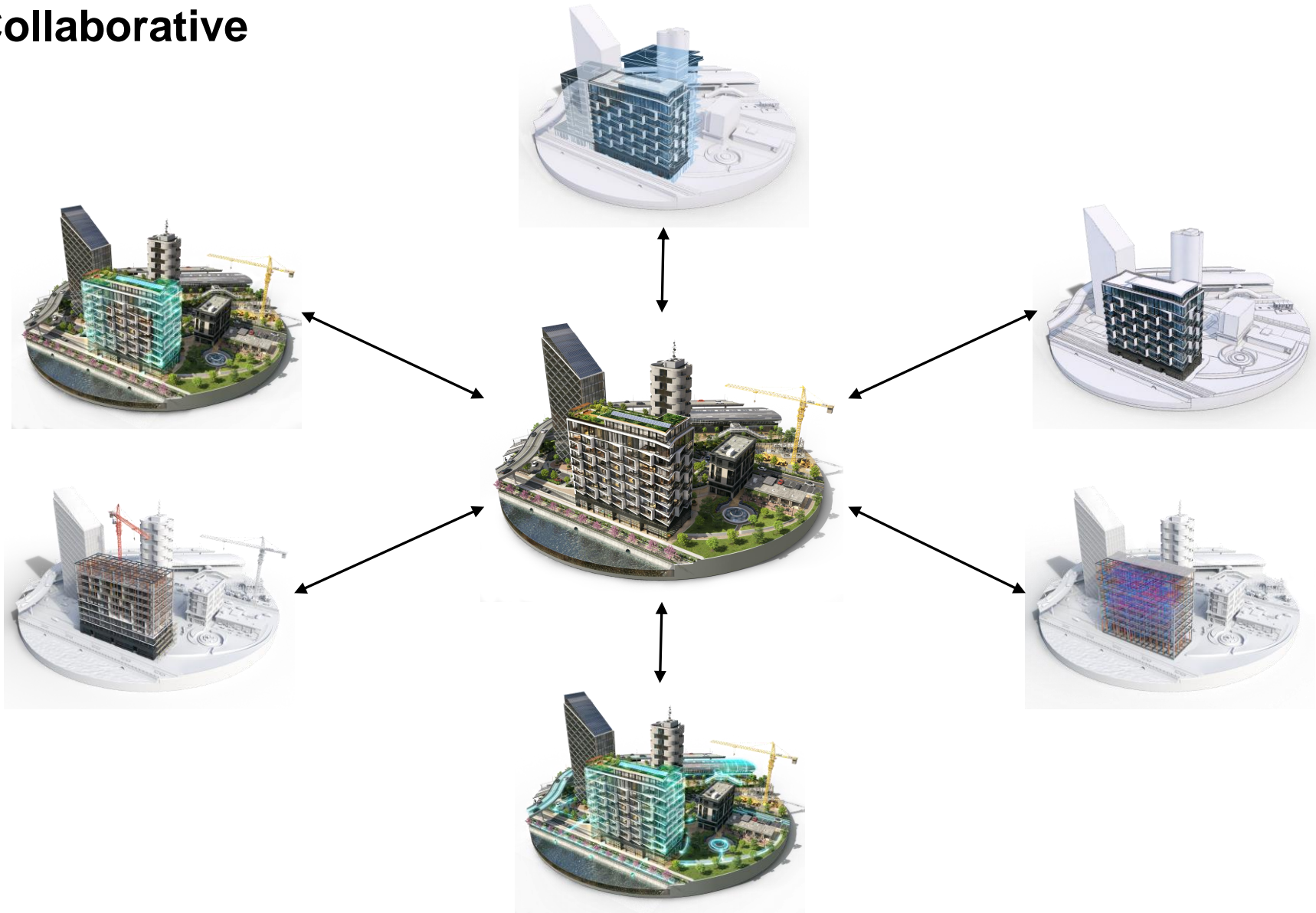



# Anytime, anywhere collaboration

## Data Sharing

- [Revit Cloud Worksharing] Co-author Revit models in the cloud at the same time, with anyone from anywhere, outside company firewall
- [Collaboration for Civil 3D] Collaborate on Civil 3D design files, data shortcuts, and XRefs with automated file locking with anyone, from anywhere outside company firewall
- [Collaboration for Plant 3D] Securely share Plant 3D files and references across teams or company firewalls. Manage permissions, maintain compliance requirements, and keep teams aligned in a common data environment





# The Single Source of Truth

## Common data environment

### Data Sharing

- Store and manage all project data, in one location to improve efficiency during handover

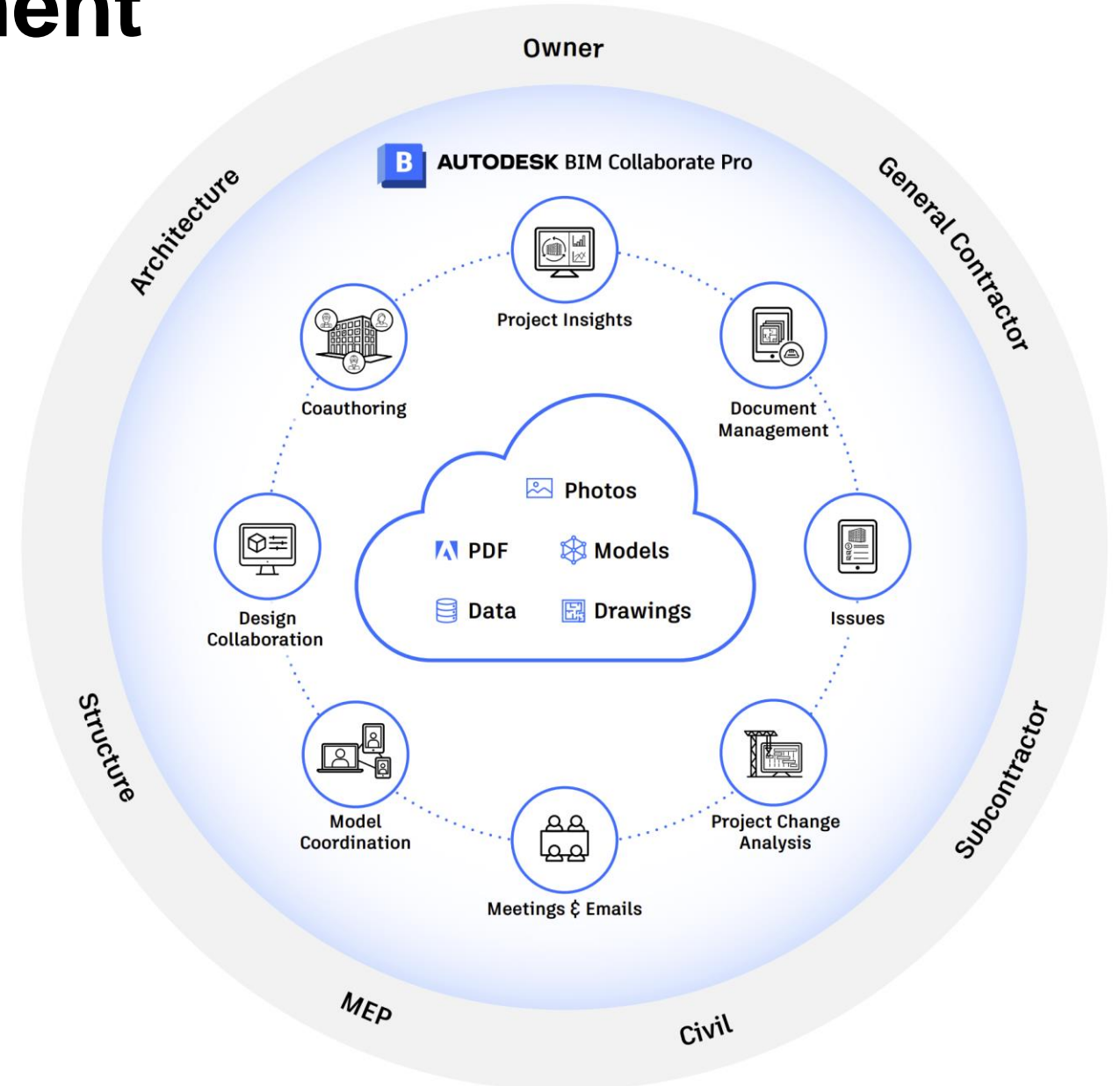

# Design Review on-the-go

## Data Sharing

- View and compare iterations of sheet layouts side-by-side or combined views of the project model in 3D view. No exports, translations, or uploads required.
- Share & markup over 50 2D & 3D design file formats including Revit (RVT), Navisworks (NWD, NWF), AutoCAD (DWG, XREF, DREF), industry formats like IFC, and office file types.

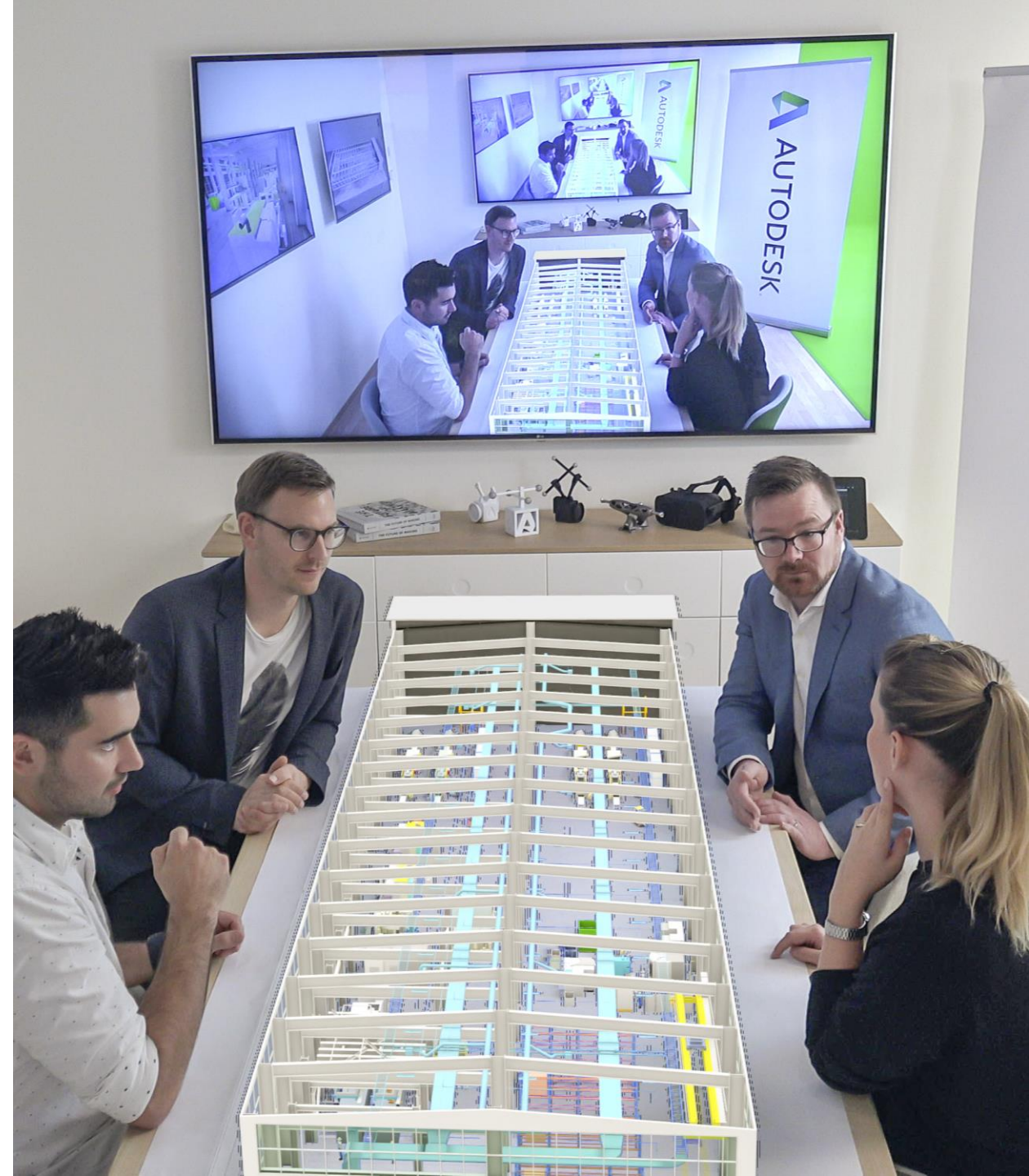



# Automated clash detection

## Digital Governance

- Upload models to automatically detect clashes. View results in an intuitive matrix, identifying clashes and grouping them to prioritize work.
- Explore design options by running clash analysis against shared models in sandboxed folders called “coordination spaces”, separating design trials from live ongoing work



**Quality**



# Digital Governance

Becoming Collaborative



# Manage design data exchange & submittals

## Digital Governance

- Track and share design packages against deadlines on a project timeline.
- Facilitate simultaneous design work among multidiscipline teams with advanced permissions in folder settings, keeping other teams out of work-in-progress files





# Centralized Issue Management

## Digital Governance

- Create and track issues on design data, assigning due date, responsible party, and root cause to ensure closure. View and resolve issues assigned to you from the cloud directly in Revit or Navisworks for closed-loop workflows (currently available for BIM 360 only)



**Traceability**  
**Transparency**  
**Accountability**





Autodesk and the Autodesk logo are registered trademarks or trademarks of Autodesk, Inc., and/or its subsidiaries and/or affiliates in the USA and/or other countries. All other brand names, product names, or trademarks belong to their respective holders. Autodesk reserves the right to alter product and services offerings, and specifications and pricing at any time without notice, and is not responsible for typographical or graphical errors that may appear in this document.

© 2022 Autodesk. All rights reserved.